

ROTARY COMMUNITY PARK - MASTERPLAN

Rotary Club of
Perrysburg, Ohio

City of Perrysburg



&

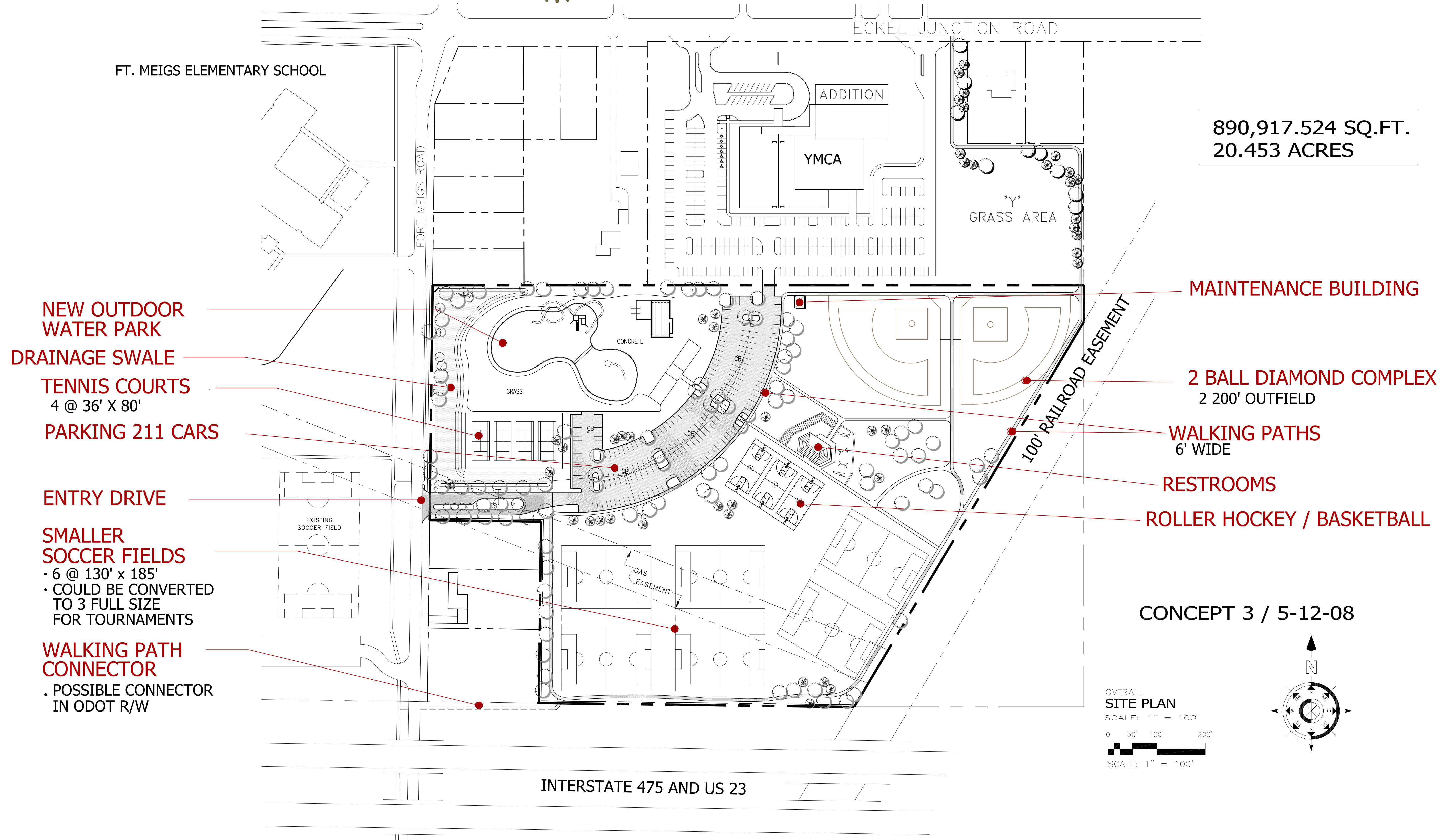
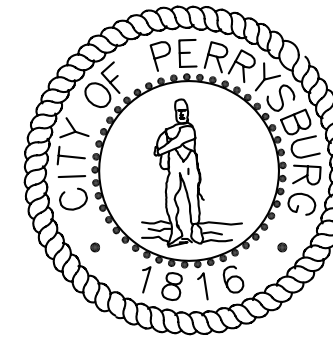

890,917.524 SQ.FT.
20.453 ACRES

- NEW OUTDOOR WATER PARK
- DRAINAGE SWALE
- TENNIS COURTS
4 @ 36' X 80'
- PARKING 211 CARS
- ENTRY DRIVE
- SMALLER SOCCER FIELDS
• 6 @ 130' x 185'
• COULD BE CONVERTED TO 3 FULL SIZE FOR TOURNAMENTS
- WALKING PATH CONNECTOR
• POSSIBLE CONNECTOR IN ODOT R/W

- MAINTENANCE BUILDING
- 2 BALL DIAMOND COMPLEX
2 200' OUTFIELD
- WALKING PATHS
6' WIDE
- RESTROOMS
- ROLLER HOCKEY / BASKETBALL

CONCEPT 3 / 5-12-08

OVERALL SITE PLAN
SCALE: 1" = 100'
0 50' 100' 200'
SCALE: 1" = 100'

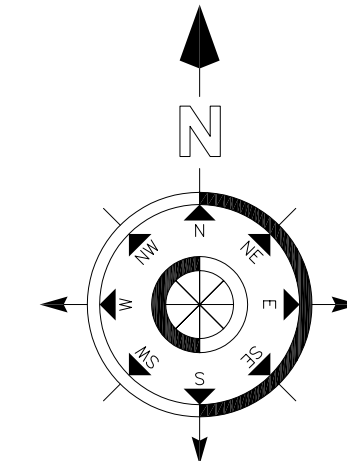

normand associates, inc.
architects planners
885 commerce drive, perrysburg, ohio
(419)874-0916 fax 874-0919 43551

ROTARY COMMUNITY PARK
PERRYSBURG, OHIO

DATE	DESCRIPTION	FILE NAME	JOB NO.
		0616-01 SITE PLAN.DWG	0616
		CREATED: 4/16/2008	DRAWN BY
		PLOTTED: 8/5/2008	LOR
		SHEET	OF